



If you have any questions contact  
In the U.S.A.: 1-800-211-PANA (7262)  
In Canada: 1-800-561-5505

### Dear customer

Thank you for purchasing this product.  
Before connecting, operating or adjusting this product, please read the instructions completely.  
Please keep this manual for future reference.

These instructions are applicable to the following systems.

<b>System</b>	SC-EN37
<b>Main unit</b>	SA-EN37
<b>Speakers</b>	SB-EN37 SB-EN37A



## Troubleshooting guide

Before requesting service, make the following checks. If you are in doubt about any of the check points, or if the solutions indicated in the chart do not solve the problem, refer to the "Customer Services Directory" on page 7 if you reside in the U.S.A, or refer to the "Product information" on page 7 if you reside in Canada.

<b>No play.</b>	<ul style="list-style-type: none"> <li>The disc isn't correctly set.</li> <li>The disc is scratched or dirty. (Tracks skipped.)</li> <li>There is moisture on the lens. Wait for about an hour and then try again.</li> </ul>
<b>MP3 cannot be read.</b>	<ul style="list-style-type: none"> <li>You may not be able to play MP3 if you have copied a multi-session disc that has no data between sessions.</li> <li>When creating a multi session disc, it is necessary to close the session.</li> <li>The amount of data on the disc is too small. Set the amount of data to greater than approximately 5 MB.</li> </ul>
<b>Sound is unfixed, reversed or comes from one speaker only.</b>	<ul style="list-style-type: none"> <li>Check the speaker connections. (⇒ page 3)</li> </ul>
<b>No sound or there is a lot of noise.</b>	<ul style="list-style-type: none"> <li>Noise may occur when playing MP3 if recording quality is poor.</li> <li>Keep this unit away from mobile telephones if the interference is apparent.</li> <li>Turn the volume up.</li> <li>Switch the unit off, determine and correct the cause, then switch the unit on. Causes include shorting of the positive and negative speaker wires, straining of the speakers through excessive volume or power, and using the unit in a hot environment.</li> </ul>
<b>Humming heard during play.</b>	<ul style="list-style-type: none"> <li>An AC power supply cord or fluorescent light is near the cords. Keep other appliances and cords away from this unit's cables.</li> </ul>
<b>A beat sound or noise is heard while receiving a radio broadcast.</b>	<ul style="list-style-type: none"> <li>Switch the TV or other audio player off or separate it from the unit.</li> <li>Switch off the portable audio player connected to "MUSIC PORT".</li> </ul>
<b>A low hum or noise is heard during AM broadcasts.</b>	<ul style="list-style-type: none"> <li>Keep the antenna away from other cables and cords.</li> <li>Keep the AM antenna away from the unit.</li> </ul>
<b>The picture on the television near the set disappears or stripes appear on the screen.</b>	<ul style="list-style-type: none"> <li>The location and orientation of the antenna are incorrect.</li> <li>The television antenna wire is too close to the unit. Separate the antenna wire of the television from the unit.</li> </ul>
<b>Remote control doesn't work.</b>	<ul style="list-style-type: none"> <li>Check that the batteries are inserted correctly. (⇒ page 2)</li> <li>Replace the batteries if they are worn.</li> </ul>

### Display

--:--	<ul style="list-style-type: none"> <li>You plugged the AC power supply cord in for the first time and there was a power failure recently. Set the time. (⇒ page 6)</li> </ul>
PGM FULL	<ul style="list-style-type: none"> <li>The number of programmed tracks is limited to 24. No further tracks can be programmed.</li> </ul>
NO PLAY	<ul style="list-style-type: none"> <li>A CD-ROM disc that is not CD-DA or MP3 format is inserted. It cannot be played.</li> </ul>
ERROR	<ul style="list-style-type: none"> <li>Incorrect operation performed. Read the instructions and try again.</li> </ul>
F76	<ul style="list-style-type: none"> <li>There is a power supply problem. Consult the dealer.</li> </ul>

### iPod®

<b>iPod does not turn on.</b>	<ul style="list-style-type: none"> <li>Verify that the iPod battery is not depleted by attempting to turn it on without connecting it to the CD Stereo System.</li> <li>Turn off both your CD Stereo System and iPod before inserting it to the Dock. Power on the CD Stereo System and select the appropriate source.</li> </ul>
<b>No sound is coming from the speakers.</b>	<ul style="list-style-type: none"> <li>The iPod is not correctly seated into the Dock. Turn off the iPod, remove it from the Dock connector. Reseat it and turn it on again.</li> <li>Make sure that iPod is actually playing something.</li> <li>Adjust the volume.</li> </ul>
<b>Music is distorted or the sound level is too low.</b>	<ul style="list-style-type: none"> <li>Check and make sure the equalizer function of your iPod is turned OFF .</li> </ul>
<b>Cannot control the iPod from the CD Stereo System.</b>	<ul style="list-style-type: none"> <li>Make sure the iPod is inserted properly into the Dock.</li> <li>Check the Dock connection and make sure that OPTION port is selected as the source of music. (⇒ page 5)</li> </ul>
<b>iPod does not charge.</b>	<ul style="list-style-type: none"> <li>Check all connections. (⇒ page 3)</li> </ul>

Panasonic Consumer Electronics  
Company, Division of Panasonic  
Corporation of North America  
One Panasonic Way Secaucus,  
New Jersey 07094  
<http://www.panasonic.com>

©2007 Matsushita Electric Industrial Co., Ltd.  
Printed in Malaysia

Panasonic Puerto Rico, Inc.  
Ave. 65 de Infantería, Km. 9.5  
San Gabriel Industrial Park, Carolina,  
Puerto Rico 00985

Panasonic Canada, Inc.  
5770 Ambler Drive  
Mississauga, Ontario  
L4W 2T3  
[www.panasonic.ca](http://www.panasonic.ca)



## Supplied accessories



Use the numbers indicated in parentheses when asking for replacement parts.

(As of January 2007)

To order accessories, refer to "Accessory Purchases" on page 7.

1 Remote control (⇒ page 2) (N2QAYB000109)

1 AC power supply cord (⇒ page 3) (K2CB2CB00018)

1 FM/AM antenna (⇒ page 3) (N1DADY00003)

2 Batteries (⇒ page 2)

1 Universal Dock for iPod (⇒ page 5) (RFE0205)

- The included AC power supply cord is for use with this unit only. Do not use it with other equipment.
- Do not use an AC power supply cord from other equipment.

## The remote control

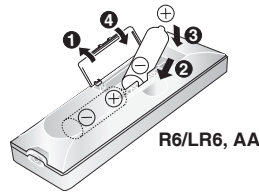

Remote control signal sensor

### Batteries

- Insert so the poles (+ and -) match those in the remote control.
- Do not use rechargeable type batteries.

### Use

- Aim at the sensor, avoiding obstacles, at a maximum range of 7 m directly in front of the unit.
- Operation can be affected by strong light sources, such as direct sunlight, and the glass doors on cabinets.

## Control guide

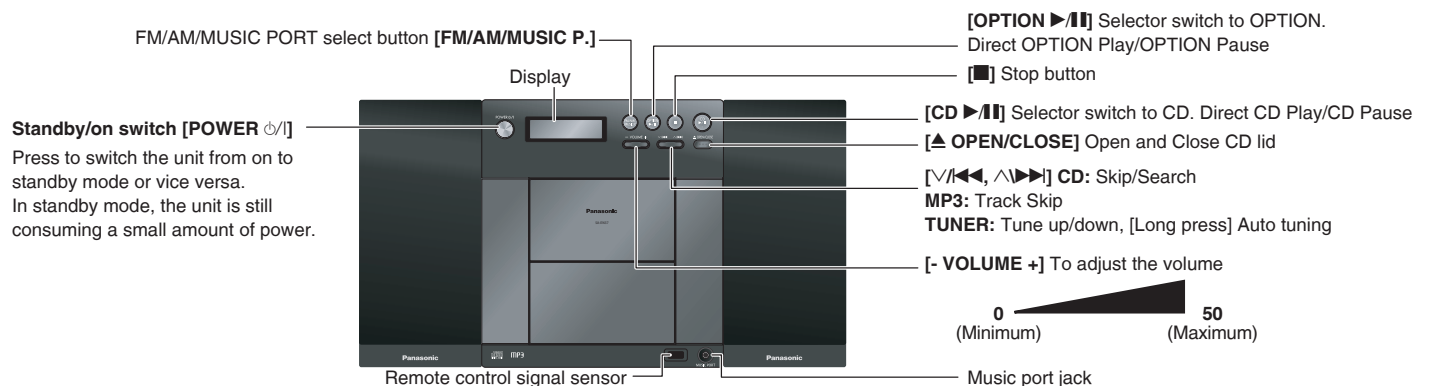
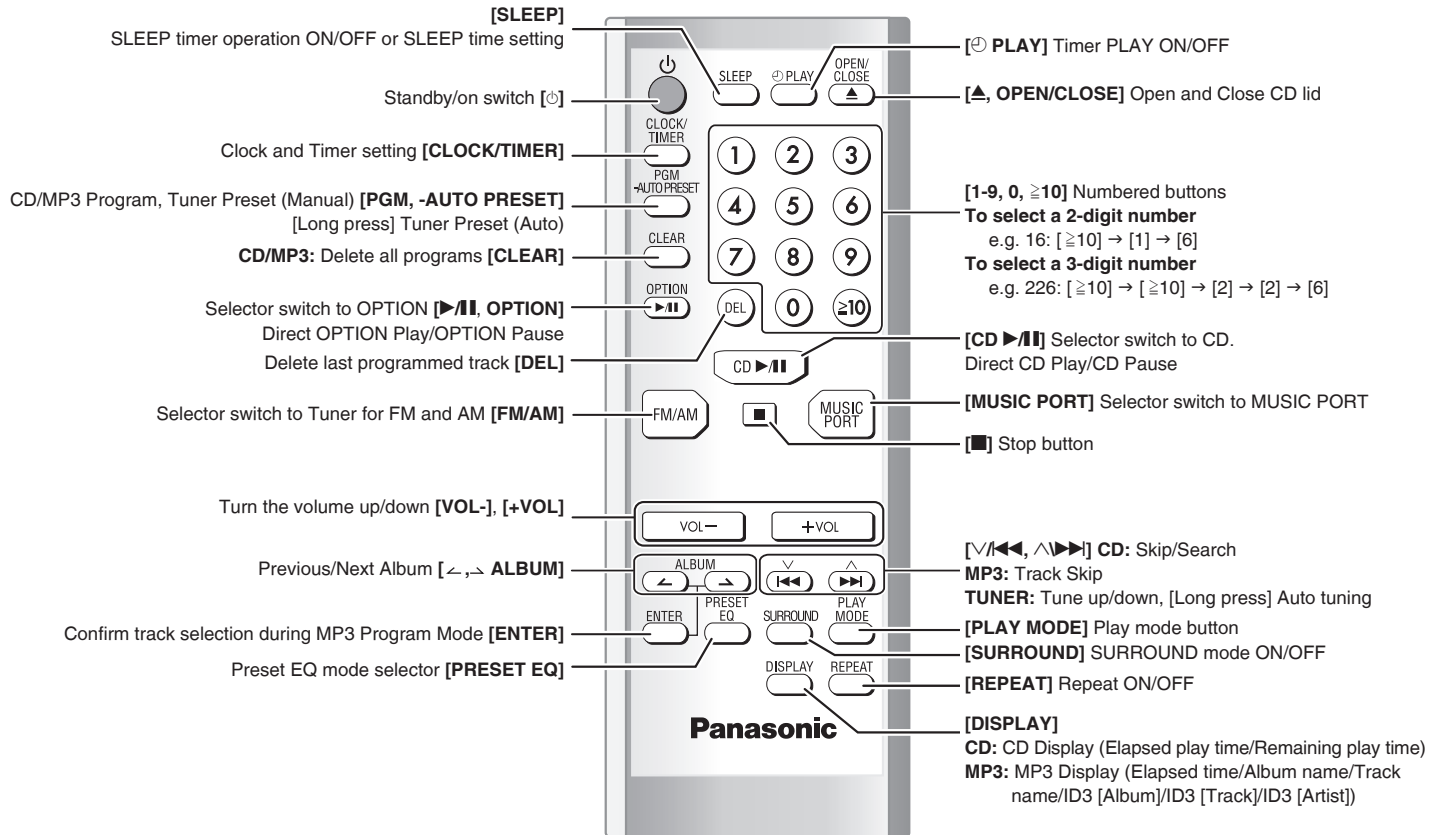

## Placement of speakers

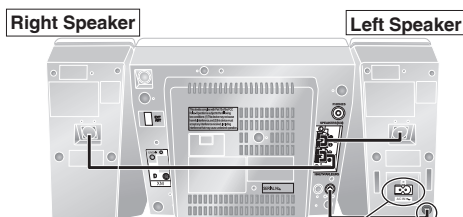

AC power supply cord DC in cord to connect to main set

Left and right speakers are different.

### Note

- Keep your speakers at least 10 mm (13/32") away from the system for proper ventilation.
- These speakers do not have magnetic shielding. Do not place them near televisions, personal computers or other devices easily influenced by magnetism.
- You cannot take the front net off the speakers.



### Caution

- Use the speakers only with the recommended system. Failure to do so may lead to damage to the amplifier and/or speakers, and may result in the risk of fire. Consult a qualified service person if damage has occurred or if you experience a sudden change in performance.
- Do not attach these speakers to walls or ceilings.

1. Speakers

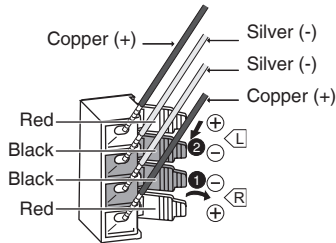

4. AC power supply cord

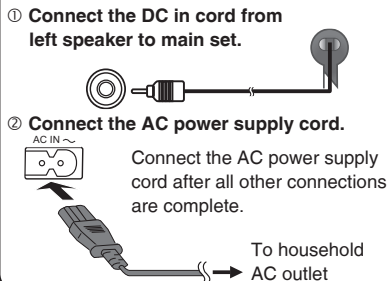

Conserving power

The unit consumes 2.0 W even it is turned off with [POWER  $\phi$ /I]. To save power when the unit is not to be used for a long time, unplug it from the household AC outlet. Remember to reset the radio stations and any other memory items before using the unit again.

Note

If the unit is left unplugged for longer than approximately two weeks, all settings will revert to the factory settings.

2. FM/AM antenna

Stand the antenna up on its base.

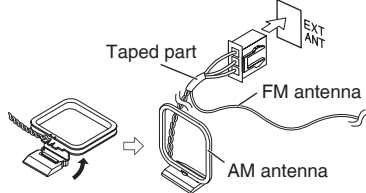

Unplug the antenna connector by holding the taped part.

3. iPod connection

Proceed to step 4 if you are not connecting an iPod to the main unit.

Connect the Universal Dock for iPod to OPTION port.



→ Refer to page 5 for further information.

Headphones

(not included)

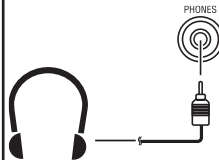

Reduce the volume level and connect the headphones.  
Plug type: 3.5 mm (1/8") stereo.

Note

To prevent hearing damage avoid listening for prolonged periods of time.

Portable audio equipment

(Cords and equipment not included)

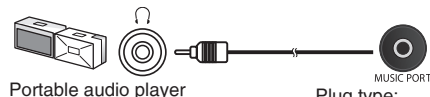

Portable audio player

Plug type:  
3.5 mm (1/8") stereo

Use MAIN UNIT REMOTE CONTROL

Start Playback from the Portable audio source.

Note

- Adjust the volume and sound quality of this unit and the other equipment.
- For details, refer to the instruction manual of the other equipment.

Discs operations

Basic play

- Press [POWER  $\phi$ /I] to turn the unit on.
- Press [ $\blacktriangle$  OPEN/CLOSE] to open the CD lid and then set the CD in place. Press [ $\blacktriangle$  OPEN/CLOSE] again to close the lid. Keep fingers away from the CD lid when it is closing to avoid possible minor injury.

Label must face outward.  
Press until you hear it click into place.



- Press [CD  $\blacktriangleright$ /II] to start play.
- Adjust the volume.

Note

- Be sure to press the [ $\blacktriangle$  OPEN/CLOSE] button to open and close the CD lid.
- Damage may occur if the lid is forced closed.
- During standby, if the CD is ready in the unit, the unit comes on and play begins. (One touch play)

Stop	Press [■].
Pause	Press [CD $\blacktriangleright$ /II]. Press again to resume play.
Skip/Search	Press [V/◀◀] or [V/▶▶] to skip/ Press and hold [V/◀◀] or [V/▶▶] to search. <b>Note</b> • You can search during play or while paused. • You cannot search through MP3 files. • You can only search within the current track during program play, one track repeat, and random play.
Skip album	Press [ALBUM ◀ or ▶] in the play mode. Press [ALBUM ◀ or ▶] once and then the numbered buttons in the stop mode.
Direct access play (Play starts with the track you select.)	<b>CD</b> Press the numbered buttons to select the desired track. <b>MP3</b> ① Press [ALBUM ◀ or ▶] to select the album. ② Press [V/▶▶] once and then press the numbered buttons to select the desired track.

Program play

The function allows you to program up to 24 tracks.

- CD** Press [PGM, -AUTO PRESET] while stopped.
- Press the numbered buttons to select tracks. (Maximum 24 tracks) Repeat this step to program other tracks.
- Press [CD  $\blacktriangleright$ /II] to start play.

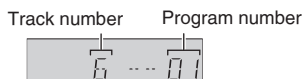

MP3

- Press [PGM, -AUTO PRESET] while stopped.
- Press [ALBUM ◀ or ▶] to select your desired album.
- Press [V/▶▶] once and then press the numbered buttons to select tracks. (Maximum 24 tracks)
- Press [ENTER]. Repeat step 2 to 4 to program other tracks.
- Press [CD  $\blacktriangleright$ /II] to start play.



Confirm a programmed track	Press [V/◀◀] or [V/▶▶] when "PGM" is displayed in the stop mode. To check while programming, press [PGM, -AUTO PRESET] twice after "PGM" appears, then press [V/◀◀] or [V/▶▶].
Delete all programs	Press [CLEAR] in the stop mode. "CLR ALL" is displayed.
Cancel program mode	Press [PGM, -AUTO PRESET] in the stop mode to clear "PGM" indicator from the display.

Note

Program contents are stored in the unit's memory even after changing to a different function or turning the unit off. All program contents are erased by pressing [CLEAR] or by opening the CD lid.

## Play Mode function

PLAY  
MODE

Press [PLAY MODE] to select the desired mode.

Mode	To play
1-TRACK 1TR	one selected track on the disc. Press the numbered buttons to select the track.
1-ALBUM MP3 1ALBUM	one selected album on the disc. Press [ALBUM ← or →] to select the album.
RANDOM RND	a disc randomly.
1-ALBUM RANDOM MP3 1ALBUM RND	all tracks in one selected album randomly. Press [ALBUM ← or →] to select the album.

## Note

- During random play, you cannot skip to previous track.

## Note on CD-R and CD-RW

This unit can play CD-R and CD-RW recorded with CD-DA or MP3. Use an audio recording disc for CD-DA and finalize\* it when you finish recording.

The unit may not be able to play some discs due to the condition of the recording.

A process performed after recording that enables CD-R/CD-RW players to play audio CD-R and CD-RW.

## Caution

Choose discs with this mark:

- Do not:
- use irregularly shaped CDs.
  - attach extra labels and stickers.
  - use CDs with labels and stickers that are coming off or with adhesive exuding from under labels and stickers.
  - attach scratch-proof covers or any other kind of accessory.
  - write anything on the CD.
  - clean CDs with liquids (Wipe with a soft, dry cloth.).



## Note about using a DualDiscs

- The digital audio content side of a DualDiscs does not meet the technical specifications of the Compact Disc Digital Audio (CD-DA) format, so play may not be possible.
- Do not use a DualDiscs in this unit as it may not be possible to insert it correctly and it may get scratched or scraped.

## Repeat play

REPEAT

You can repeat program play or other selected play mode.

Press [REPEAT] before or during play.  
"REPEAT ON" and "↺" are displayed.

## To cancel

Press [REPEAT] again.

"REPEAT OFF" is displayed and "↺" is cleared.

## Display function

DISPLAY

This function allows you to display the information of the current track.

Press [DISPLAY] repeatedly during play or pause.

CD



MP3

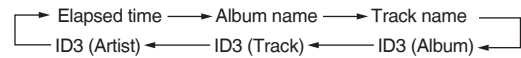

## Note

- Maximum number of displayable characters: approximately 30
- This unit supports ver. 1.0 & 1.1 ID3 tags. Text data that is not supported will not be displayed.
- ID3 is a tag embedded in MP3 tracks to provide information about the track.

MP3

The unit can play MP3, a method of compressing audio without overly hurting audio quality.

## When creating MP3 files to play on this unit

- Maximum number of tracks and albums: 999 tracks and 256 albums.
- Compatible compression rate: Between 64 kbps and 320 kbps (stereo).  
128 kbps (stereo) is recommended.
- Disc formats: ISO9660 level 1 and level 2 (except for extended formats).
- The time for reading TOC depends on the number of the tracks, the folders or folder structures.

## Limitations on MP3

- This unit is compatible with multi-session but if there are a lot of sessions it takes more time for play to start. Keep the number of sessions to a minimum to avoid this.
- This unit cannot play files recorded using packet write.
- If the disc includes both MP3 and normal audio data (CD-DA), the unit plays the type recorded in the inner part of the disc.  
If the disc includes both MP3 and other types of audio data (e.g. WMA or WAV), the unit plays only the MP3.
- Depending on how you create MP3 files, they may not play in the order you numbered them or may not play at all.

## Radio operations

## Allocation settings

Each country allocates broadcast bands according to their particular system. You can change the FM steps. The step is factory-set to 0.2 MHz, but you can change it to receive broadcasts allocated 0.1 MHz steps. Any FM/AM frequencies preset in channels will be changed by this procedure. Preset them again.

① Select the FM band with [FM/AM/MUSIC P.] on the unit.

② Press and hold [FM/AM/MUSIC P.] on the unit.

After a few seconds the display changes to show the current minimum frequency. Continue to hold the button down. The minimum frequency changes and the step is changed.

To return to the original step, repeat the above steps.

## Note

The preset memory will be initialized when you change your frequency step.

## To improve reception

FM

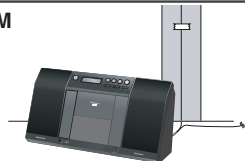

Receive the radio stations after connecting the antenna. Then attach the antenna cord to a wall or pillar where there is good reception.

AM



Change the direction and location of the antenna.

## To improve FM sound quality

Press and hold [PLAY MODE] to display "MONO".

MONO

## To cancel

Press and hold [PLAY MODE] again until "MONO" disappears.

- MONO is also canceled if the frequency is changed.
- Turn off "MONO" for normal listening.

## Manual tuning

① Press [FM/AM] to select "FM" or "AM".

② Press [PLAY MODE] to select "MANUAL".

③ Press [↖/◀◀] or [↗/▶▶] to select the frequency of the required station.

## To tune automatically

① Press [FM/AM] to select "FM" or "AM".

② Press [PLAY MODE] to select "MANUAL".

③ Press and hold [↖/◀◀] or [↗/▶▶] until the frequency starts changing rapidly.

- Auto tuning stops when it finds a station.

• To cancel auto tuning, press [↖/◀◀] or [↗/▶▶] once again.

## Note

- Auto tuning may not function when there is excessive interference.

## Memory preset

You can preset up to 20 FM channels and up to 12 AM channels.

**Preparation:** Press [FM/AM] to select "FM" or "AM".

## Automatic presetting

Press and hold [PGM, -AUTO PRESET] to start presetting.

## Manual presetting

① Press [PLAY MODE] to select "MANUAL".

② Press [↖/◀◀] or [↗/▶▶] to tune to the required station.

③ Press [PGM, -AUTO PRESET].

④ Press the numbered buttons to select a channel.

The station occupying a channel is erased if another station is preset in that channel.

⑤ Repeat steps 2 to 4 to preset more stations.

## Selecting a preset station

Press the numbered buttons to select the channel.

For channels 10 to 20 press [≥10], then the two digits.

## OR

① Press [PLAY MODE] to select "PRESET".

② Press [↖/◀◀] or [↗/▶▶] to select the channel.



Enjoying audio from iPod



■ Connecting the iPod

Dock adapter for iPod nano 2nd generation (aluminum) (2GB, 4GB, 8GB)	Dock adapter for iPod 5th generation (video) (60GB, 80GB)	Dock adapter for iPod 5th generation (video) (30GB)
11	10	9

The mark **11**, **10** or **9** is shown on the back of each dock adapter.

- For other types of iPod, please use the dock adapter sold separately.

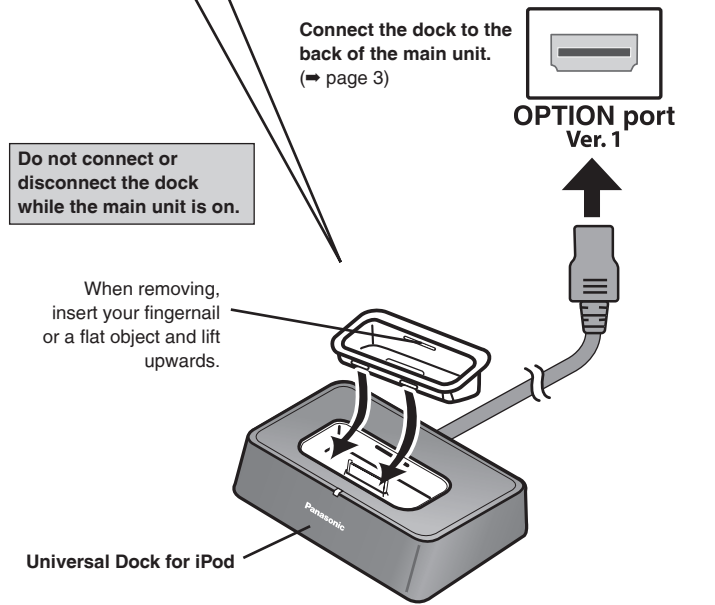

■ Charging the iPod

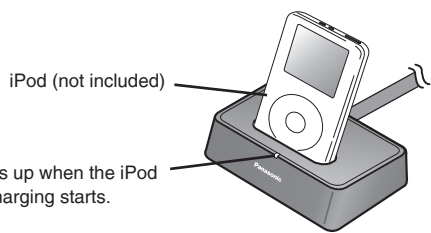

iPod nano 2nd generation (aluminum) iPod 5th generation (video) iPod nano 1st generation	Until iPod is fully charged
iPod 4th generation (color display) iPod 4th generation iPod mini	5 hours (fixed)

Note

- AC power cord and DC in cord must be connected to the CD stereo system.
- "OPTION \*" will be shown on the main unit display during iPod charging in main unit standby mode. It will go off when charging is finished.
- For the above models under "fixed 5-hour charging", "OPTION \*" continues to be displayed throughout this duration, even when your iPod is fully charged. You can turn off this display by removing the iPod from the dock.
- Compatibility depends on the software version of your iPod.

■ Playing the iPod

Preparation:

- Reduce the volume of the main unit.
- Confirm the iPod connection. (→ left)

- Press [OPTION ▶/||] to play the iPod.
- Adjust the volume of the main unit.

	Remote control	Main unit
To pause track	OPTION	
To skip a track (During play/pause)		
To search the current track (During play/pause)	press and hold	press and hold

When you select another source, or turn the main unit off, the iPod turns off.

■ Compatible iPod

Name	Memory size
iPod nano 2nd generation (aluminum)	2GB, 4GB, 8GB
iPod 5th generation (video)	60GB, 80GB
iPod 5th generation (video)	30GB
iPod nano 1st generation	1GB, 2GB, 4GB
iPod 4th generation (color display)	40GB, 60GB
iPod 4th generation (color display)	20GB, 30GB
iPod 4th generation	40GB
iPod 4th generation	20GB
iPod mini	4GB, 6GB

- Compatibility depends on the software version of your iPod.

iPod is a trademark of Apple Inc., registered in the U.S. and other countries.

Changing the main unit and remote control mode

The remote control and main unit are factory-set to "REMOTE 1" mode. If your remote control affects other equipment during operation, you can switch to operate in "REMOTE 2" mode.



To switch to "REMOTE 2" mode

- (While pressing and hold [OPTION ▶/||] on the main unit) Press and hold [2] until "REMOTE 2" appears on the main unit display.
- Press and hold [ENTER] and [2] for at least 2 seconds. The main unit and remote control are now set to operate in "REMOTE 2" mode.

To return to "REMOTE 1" mode

Perform steps 1 and 2 above but use [1] instead of [2] for both steps. ("REMOTE 1" appears on the main unit during step 1.)

The remote control cannot work with the main unit if their modes are different. "REMOTE 1" or "REMOTE 2" appears on the main unit when you operate the remote control.\*

- \* If "REMOTE 1" appears (The main unit is in "REMOTE 1" mode.) Press and hold [ENTER] and [1] on the remote control for at least 2 seconds. If "REMOTE 2" appears (The main unit is in "REMOTE 2" mode.) Press and hold [ENTER] and [2] on the remote control for at least 2 seconds.

Setting the time



This is a 12-hour clock.

- ① Press [CLOCK/TIMER] to set the clock.
- ② Press [V/◀] or [▶/V] to select the time within 5 seconds. (Press and hold to change the time faster.)
- ③ Press [CLOCK/TIMER] again.

- To display the clock when the unit is on Press [CLOCK/TIMER]
- To check the time when the unit is off Press [CLOCK/TIMER]

Note

The clock is accurate to within ±60 seconds a month. Readjust if necessary. Set again after disconnecting the AC power supply cord or power failure.

Sleep timer



The SLEEP timer can turn the unit off after a set time. Press [SLEEP] to turn the SLEEP function ON/OFF.

- Each time you press the button:  
30 MIN → 60 MIN → 90 MIN → 120 MIN  
↑ OFF (Canceled) ↓

- To check the remaining time Press [SLEEP] once

Note

The play timer and sleep timer can be used together. The sleep timer always has priority. Be sure not to overlap timer settings.

Sound quality



You can choose one of four types of sound quality.

Press [PRESET EQ] to select the sound quality.

- Each time you press the button:  
HEAVY (Adds punch to rock) → CLEAR (Clarifies higher sounds) → SOFT (For background music)  
EQ OFF (Canceled) ← VOCAL (Adds gloss to vocals) ←

Live Virtualizer



You can create a three-dimensional sound field when listening to stereo sound.

Press [SURROUND] to turn the Live Virtualizer ON/OFF.

Note

The actual effect depends on the source played.

Play timer



You can set the timer to come on at a certain time to wake you up.

Preparation:

Turn the unit on and set the clock. Prepare the music source you want to listen to; disc, radio, OPTION or music port source, and set the volume.

- ① Press [CLOCK/TIMER] repeatedly to select play timer.

CLOCK → PLAY → Original display

- ② "ON TIME" is displayed. Within 5 seconds, press [V/◀] or [▶/V] to set the starting time.

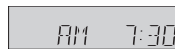

- ③ Press [CLOCK/TIMER] to confirm.

- ④ "OFF TIME" is displayed. Repeat steps 2 and 3 to set the finishing time.



To activate the timer

- ⑤ Press [PLAY] to turn on the timer.
- ⑥ Press [ ] to turn off the unit.

To	Action
Change the settings	Repeat steps 1 to 4 and 6.
Change the source of volume	① Press [PLAY] to clear PLAY indicator from the display. ② Make changes to the source or volume. ③ Perform steps 5 and 6.
Check the settings (when the unit is on or in standby mode)	Press [CLOCK/TIMER] repeatedly to select PLAY.
Cancel	Press [PLAY] to clear the timer indicator from the display.

Note

- The timer will start at the preset time, with the volume increasing gradually to the preset level.
- The timer comes on at the set time every day if the timer is on.
- The unit must be in the standby mode for the timer to function.
- If you turn the unit off and on again while the timer is functioning, the finish time setting will not be activated.
- When MUSIC PORT or OPTION port is selected as the source when the timer comes on, the system turns on and engages MUSIC PORT or OPTION port as the source. If you wish to playback from the portable audio equipment, activate the equipment's play mode and increase the volume. (See the portable audio equipment's instruction manual.)

Specifications

AMPLIFIER SECTION

- FTC OUTPUT POWER both channel driven simultaneously  
10 % total harmonic distortion (THD)  
1 kHz 2.8 W per channel
- RMS OUTPUT POWER both channel driven simultaneously  
10 % total harmonic distortion (THD)  
1 kHz 3 W per channel
- Output impedance  
HEADPHONE 16 Ω to 32 Ω  
MUSIC PORT 14 kΩ
- DC IN Jack  
Terminal DC 14 V
- Phone Jack  
Terminal 3.5 mm stereo
- Music Port Jack  
Terminal 3.5 mm stereo
- Option Port  
Version 1

TUNER SECTION

- Frequency range  
FM 87.9 MHz to 107.9 MHz (200 kHz)  
87.5 MHz to 108.0 MHz (100 kHz)
- AM 520 kHz to 1710 kHz (10 kHz)

CD SECTION

- Disc played [8 cm (3") or 12 cm (5")]  
(1) CD-Audio (CD-DA)  
(2) CD-R/RW (CD-DA, MP3)  
(3) MP3
- Sampling frequency  
CD 44.1 kHz  
MP3 32 kHz, 44.1 kHz, 48 kHz
- Bit rate  
MP3 32 kbps to 384 kbps
- Decoding 16/20/24 bit linear
- Pick up  
Wavelength 785 nm  
Laser power CLASS 1
- Audio Output (Disc)  
Number of channels 2 channel
- Frequency response 20 Hz to 20 kHz (+1, -2 dB)
- Wow and flutter Below measurement limit
- Digital filter 8
- D/A converter MASH (1 bit DAC)

GENERAL

- Power supply AC 120 V, 60 Hz
- Power consumption 30 W
- Dimensions (W x H x D) 220 mm x 236 mm x 146 mm (8 21/32" x 9 9/32" x 5 3/4")
- Mass  
With speakers 3.57 kg (7.87 lbs)  
Without speakers 1.27 kg (2.80 lbs)
- Operating temperature range +5 °C to +35 °C (+41 °F to +95 °F)
- Operating humidity range 5 % to 90 % RH (no condensation)

SPEAKER SECTION

- Type 1 Way, 1 Speaker system
- Speaker(s)  
Full Range Speaker 8 cm (5 1/2") cone type 6 Ω
- Impedance 6 Ω
- Input power 6 W (MAX)
- Dimensions (W x H x D) 121 mm x 236 mm x 146 mm (4 3/4" x 9 9/32" x 5 3/4")

Power consumption in standby mode: 2.0 W (approx.)

Notes:

Specifications are subject to change without notice. Mass and dimensions are approximate.

Maintenance

If the surfaces are dirty

- To clean this unit, wipe with a soft, dry cloth.
- Never use alcohol, paint thinner or benzine to clean this unit.
- Before using chemically treated cloth, read the instructions that came with the cloth carefully.

Care of the CD lens

- Clean the lens regularly to prevent malfunctions. Use a blower to remove dust and a cotton swab if it is extremely dirty. Recommended product: Lens cleaner kit (part no. SZZP1038C).
- Do not use the lens cleaner of the CD type.

## Panasonic Audio Products Limited Warranty

### Limited Warranty Coverage

If your product does not work properly because of a defect in materials or workmanship, Panasonic Consumer Electronics Company or Panasonic Puerto Rico, Inc. (collectively referred to as "the warrantor") will, for the length of the period indicated on the chart below, which starts with the date of original purchase ("warranty period"), at its option either (a) repair your product with new or refurbished parts, or (b) replace it with a new or a refurbished product. The decision to repair or replace will be made by the warrantor.

Product or Part Name	Parts	Labor
Audio Products (except items listed below)	One (1) year	One (1) year
USB Reader-Writer, Personal Computer Card Adapters (in exchange for defective item)	One (1) year	Not Applicable
Accessories: Headphones, Cartridges, Microphones, Adapters	Ninety (90) days	Ninety (90) days
Rechargeable Batteries, DVD-RV-RAM Discs (in exchange for defective item)	Ten (10) days	Not Applicable
SD Memory Cards, Rechargeable Battery Packs (in exchange for defective item)	Ninety (90) days	Not Applicable

During the "Labor" warranty period there will be no charge for labor. During the "Parts" warranty period, there will be no charge for parts. You must carry-in or mail-in your product during the warranty period. If non-rechargeable batteries are included, they are not warranted. This warranty only applies to products purchased and serviced in the United States or Puerto Rico. This warranty is extended only to the original purchaser of a new product which was not sold "as is". A purchase receipt or other proof of the original purchase date is required for warranty service.

### Carry-In or Mail-In Service

For Carry-In or Mail-In Service in the United States call 1-800-211-PANA (1-800-211-7262) or visit Panasonic web site: <http://www.panasonic.com>  
For assistance in Puerto Rico call Panasonic Puerto Rico, Inc. (787)-750-4300 or fax (787)-768-2910.

### Customer Services Directory

Obtain Product Information and Operating Assistance; locate your nearest Dealer or Servicenter; purchase Parts and Accessories; or make Customer Service and Literature requests by visiting our Web Site at:

<http://www.panasonic.com/consumersupport>  
or, contact us via the web at: <http://www.panasonic.com/contactinfo>  
You may also contact us directly at: 1-800-211-PANA (7262),  
Monday-Friday 9 am-9 pm; Saturday-Sunday 10 am-7 pm, EST.

For hearing or speech impaired TTY users, TTY: 1-877-833-8855

### Limited Warranty Limits And Exclusions

This warranty ONLY COVERS failures due to defects in materials or workmanship, and DOES NOT COVER normal wear and tear or cosmetic damage. The warranty ALSO DOES NOT COVER damages which occurred in shipment, or failures which are caused by products not supplied by the warrantor, or failures which result from accidents, misuse, abuse, neglect, mishandling, misapplication, alteration, faulty installation, set-up adjustments, misadjustment of consumer controls, improper maintenance, power line surge, lightning damage, modification, or commercial use (such as in a hotel, office, restaurant, or other business), rental use of the product, service by anyone other than a Factory Servicenter or other Authorized Servicer, or damage that is attributable to acts of God.

**THERE ARE NO EXPRESS WARRANTIES EXCEPT AS LISTED UNDER "LIMITED WARRANTY COVERAGE". THE WARRANTOR IS NOT LIABLE FOR INCIDENTAL OR CONSEQUENTIAL DAMAGES RESULTING FROM THE USE OF THIS PRODUCT, OR ARISING OUT OF ANY BREACH OF THIS WARRANTY.** (As examples, this excludes damages for lost time, travel to and from the servicer, loss of media or images, data or other memory content. The items listed are not exclusive, but are for illustration only.)

**ALL EXPRESS AND IMPLIED WARRANTIES, INCLUDING THE WARRANTY OF MERCHANTABILITY, ARE LIMITED TO THE PERIOD OF THE LIMITED WARRANTY.** Some states do not allow the exclusion or limitation of incidental or consequential damages, or limitations on how long an implied warranty lasts, so the exclusions may not apply to you. This warranty gives you specific legal rights and you may also have other rights which vary from state to state. If a problem with this product develops during or after the warranty period, you may contact your dealer or Servicenter. If the problem is not handled to your satisfaction, then write to the warrantor's Consumer Affairs Department at the addresses listed for the warrantor.

**PARTS AND SERVICE WHICH ARE NOT COVERED BY THIS LIMITED WARRANTY ARE YOUR RESPONSIBILITY.**

### Accessory Purchases

Purchase Parts, Accessories and Instruction Books online for all Panasonic Products by visiting our Web Site at: <http://www.pstc.panasonic.com> or, send your request by E-mail to: [npcparts@us.panasonic.com](mailto:npcparts@us.panasonic.com)  
You may also contact us directly at: 1-800-332-5368 (Phone) 1-800-237-9080 (Fax Only) (Monday - Friday 9 am to 8 pm, EST.) Panasonic Services and Technology Company 20421 84th Avenue South, Kent, WA 98032 (We Accept Visa, MasterCard, Discover Card, American Express, and Personal Checks)

For hearing or speech impaired TTY users, TTY: 1-866-605-1277

### Service in Puerto Rico

Panasonic Puerto Rico, Inc.  
Ave. 65 de Infantería, Km. 9.5, San Gabriel Industrial Park, Carolina, Puerto Rico 00985  
Phone (787)750-4300, Fax (787)768-2910

## Warranty (Canada)

Panasonic Canada Inc.  
5770 Ambler Drive, Mississauga, Ontario L4W 2T3  
PANASONIC PRODUCT - LIMITED WARRANTY

### EXCHANGE PROGRAM

Panasonic Canada Inc. warrants this product to be free from defects in material and workmanship and agrees to replace the product for a period as stated below from the date of original purchase.

Panasonic Portable / Clock Radio (without Tape, CD, MD) — One (1) year  
Panasonic Audio Product — One (1) year  
Panasonic DVD Product — One (1) year  
Accessories including rechargeable batteries — Ninety (90) days

### LIMITATIONS AND EXCLUSIONS

This warranty does not apply to products purchased outside Canada or to any product which has been improperly installed, subjected to usage for which the product was not designed, misused or abused, damaged during shipping, or which has been altered or repaired in any way that affects the reliability or detracts from the performance, nor does it cover any product which is used commercially. Dry cell batteries are also excluded from coverage under this warranty.

This warranty is extended to the original end user purchaser only. A purchase receipt or other proof of date of original purchase is required before warranty service is performed.

**THIS EXPRESS, LIMITED WARRANTY IS IN LIEU OF ALL OTHER WARRANTIES, EXPRESS OR IMPLIED, INCLUDING ANY IMPLIED WARRANTIES OF MERCHANTABILITY AND FITNESS FOR A PARTICULAR PURPOSE. IN NO EVENT WILL PANASONIC CANADA INC. BE LIABLE FOR ANY SPECIAL, INDIRECT OR CONSEQUENTIAL DAMAGES.**

In certain instances, some jurisdictions do not allow the exclusion or limitation of incidental or consequential damages, or the exclusion of implied warranties, so the above limitations and exclusions may not be applicable.

### CONTACT INFORMATION

For product information and operation assistance, please contact:

Our Customer Care Centre:  
Telephone #: (905) 624-5505  
1-800 #: 1-800-561-5505  
Fax #: (905) 238-2360  
Email link: "customer support" on [www.panasonic.ca](http://www.panasonic.ca)

For defective product exchange within the warranty period, please contact the original dealer or our Customer Care Centre.

## Product Service

- Damage requiring service**—The unit should be serviced by qualified service personnel if:
  - The AC power supply cord or AC adaptor has been damaged; or
  - Objects or liquids have gotten into the unit; or
  - The unit has been exposed to rain; or
  - The unit does not operate normally or exhibits a marked change in performance; or
  - The unit has been dropped or the cabinet damaged.
- Servicing**—Do not attempt to service the unit beyond that described in these operating instructions. Refer all other servicing to authorized servicing personnel.
- Replacement parts**—When parts need replacing ensure the servicer uses parts specified by the manufacturer or parts that have the same characteristics as the original parts. Unauthorized substitutes may result in fire, electric shock, or other hazards.
- Safety check**—After repairs or service, ask the servicer to perform safety checks to confirm that the unit is in proper working condition.

The servicer will require all components to service your system.

Therefore, should service ever be necessary, be sure to bring the entire system.

### Product information

For product information or assistance with product operation:  
In the U.S.A., refer to "Customer Services Directory" above.  
In Canada, contact the Panasonic Canada Inc. Customer Care Centre at 1-800-561-5505, or visit the website ([www.panasonic.ca](http://www.panasonic.ca)), or an authorized Servicenter closest to you.

The model number and serial number of this product can be found on either the back or the bottom of the unit.

Please note them in the space provided below and keep for future reference.

MODEL NUMBER \_\_\_\_\_  
SERIAL NUMBER \_\_\_\_\_

### User memo:

DATE OF PURCHASE \_\_\_\_\_  
DEALER NAME \_\_\_\_\_  
DEALER ADDRESS \_\_\_\_\_  
TELEPHONE NUMBER \_\_\_\_\_



**CAUTION**  
RISK OF ELECTRIC SHOCK  
DO NOT OPEN

**CAUTION:** TO REDUCE THE RISK OF ELECTRIC SHOCK, DO NOT REMOVE SCREWS. NO USER-SERVICEABLE PARTS INSIDE. REFER SERVICING TO QUALIFIED SERVICE PERSONNEL.

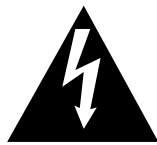

The lightning flash with arrowhead symbol, within an equilateral triangle, is intended to alert the user to the presence of uninsulated "dangerous voltage" within the product's enclosure that may be of sufficient magnitude to constitute a risk of electric shock to persons.



The exclamation point within an equilateral triangle is intended to alert the user to the presence of important operating and maintenance (servicing) instructions in the literature accompanying the appliance.

CAUTION	CLASS 1M INVISIBLE LASER RADIATION WHEN OPEN AND INTERLOCKS DEFEATED. DO NOT VIEW DIRECTLY WITH OPTICAL INSTRUMENTS. IEC60825-1 +AZI Class 1M
WARNING	KLASS 1M OSYNLIG LASERSTRÅLNING NÄR DENNA DEL ÄR ÖPPNAD OCH SPÄRREN ÄR URKOPPLAD. BETRÄKTA EJ STRÅLEN DIREKT GENOM OPTISKT INSTRUMENT
FORSIGTIG	OSYNLIG LASERSTRÅLNINGSKLASSE 1M. NÄRLAGET ER ÅBENT OG SIKKERHEDSÅBRYDERE ER UDE AF FUNKTION. UNDGÅ AT SE LØGE PÅ MED OPTISKE INSTRUMENTER
VARO	AVATTAESSA JA SUOJALUKITUS OHITETTAESSA OLET ALLTIINA LUOKAN 1M NÄKYMÄTÖNÄ LASERSÄTELYÄ. ÄLÄ KATSO OPTISELLA LAITTEELLA SUORAAN SÄTEESEEN
VORSICHT	UNSICHTBARE LASERSTRÄHLUNGSKLASSE 1M. WENN ABDECKUNG GEOFFNET UND SICHERHEITSVERRIEGELUNGEN ÜBERBRÜCKT NICHT DIREKT MIT OPTISCHEN INSTRUMENTEN BETRACHTEN
ATTENTION	RAYONNEMENT LASER INVISIBLE, CLASSE 1M. EN CAS D'OUVERTURE ET LORSQUE LA SÉCURITÉ EST NEUTRALISÉE, NE PAS REGARDER DIRECTEMENT À L'AIDE D'INSTRUMENTS D'OPTIQUE. RQLS0303

**ONLY FOR CANADA**

(Inside the product)

This product may receive radio interference caused by mobile telephones during use. If such interference is apparent, please increase separation between the product and the mobile telephone.

**WARNING:**

TO REDUCE THE RISK OF FIRE, ELECTRIC SHOCK OR PRODUCT DAMAGE,

- DO NOT EXPOSE THIS APPARATUS TO RAIN, MOISTURE, DRIPPING OR SPLASHING AND THAT NO OBJECTS FILLED WITH LIQUIDS, SUCH AS VASES, SHALL BE PLACED ON THE APPARATUS.
- USE ONLY THE RECOMMENDED ACCESSORIES.
- DO NOT REMOVE THE COVER (OR BACK); THERE ARE NO USER SERVICEABLE PARTS INSIDE. REFER SERVICING TO QUALIFIED SERVICE PERSONNEL.

**CAUTION!**

DO NOT INSTALL OR PLACE THIS UNIT IN A BOOKCASE, BUILT-IN CABINET OR IN ANOTHER CONFINED SPACE. ENSURE THE UNIT IS WELL VENTILATED. TO PREVENT RISK OF ELECTRIC SHOCK OR FIRE HAZARD DUE TO OVERHEATING, ENSURE THAT CURTAINS AND ANY OTHER MATERIALS DO NOT OBSTRUCT THE VENTILATION VENTS.

**CAUTION!**

THIS PRODUCT UTILIZES A LASER. USE OF CONTROLS OR ADJUSTMENTS OR PERFORMANCE OF PROCEDURES OTHER THAN THOSE SPECIFIED HEREIN MAY RESULT IN HAZARDOUS RADIATION EXPOSURE. DO NOT OPEN COVERS AND DO NOT REPAIR YOURSELF. REFER SERVICING TO QUALIFIED PERSONNEL.

The socket outlet shall be installed near the equipment and easily accessible. The mains plug of the power supply cord shall remain readily operable. To completely disconnect this apparatus from the AC Mains, disconnect the power supply cord plug from AC receptacle.

**-If you see this symbol-**

Information on Disposal in other Countries outside the European Union



This symbol is only valid in the European Union. If you wish to discard this product, please contact your local authorities or dealer and ask for the correct method of disposal.

**IMPORTANT SAFETY INSTRUCTIONS**

Read these operating instructions carefully before using the unit. Follow the safety instructions on the unit and the applicable safety instructions listed below. Keep these operating instructions handy for future reference.

- 1) Read these instructions.
- 2) Keep these instructions.
- 3) Heed all warnings.
- 4) Follow all instructions.
- 5) Do not use this apparatus near water.
- 6) Clean only with dry cloth.
- 7) Do not block any ventilation openings. Install in accordance with the manufacturer's instructions.
- 8) Do not install near any heat sources such as radiators, heat registers, stoves, or other apparatus (including amplifiers) that produce heat.
- 9) Do not defeat the safety purpose of the polarized or grounding-type plug. A polarized plug has two blades with one wider than the other. A grounding-type plug has two blades and a third grounding prong. The wide blade or the third prong are provided for your safety. If the provided plug does not fit into your outlet, consult an electrician for replacement of the obsolete outlet.

- 10) Protect the power cord from being walked on or pinched particularly at plugs, convenience receptacles, and the point where they exit from the apparatus.
- 11) Only use attachments/accessories specified by the manufacturer.
- 12) Use only with the cart, stand, tripod, bracket, or table specified by the manufacturer, or sold with the apparatus. When a cart is used, use caution when moving the cart/apparatus combination to avoid injury from tip-over.
- 13) Unplug this apparatus during lightning storms or when unused for long periods of time.
- 14) Refer all servicing to qualified service personnel. Servicing is required when the apparatus has been damaged in any way, such as power-supply cord or plug is damaged, liquid has been spilled or objects have fallen into the apparatus, the apparatus has been exposed to rain or moisture, does not operate normally, or has been dropped.



**FCC Note: THE FOLLOWING APPLIES ONLY IN THE U.S.A.**

This equipment has been tested and found to comply with the limits for a Class B digital device, pursuant to Part 15 of the FCC Rules. These limits are designed to provide reasonable protection against harmful interference in a residential installation. This equipment generates, uses and can radiate radio frequency energy and, if not installed and used in accordance with the instructions, may cause harmful interference to radio communications. However, there is no guarantee that interference will not occur in a particular installation. If this equipment does cause harmful interference to radio or television reception, which can be determined by turning the equipment off and on, the user is encouraged to try to correct the interference by one or more of the following measures:

- Reorient or relocate the receiving antenna.
- Increase the separation between the equipment and receiver.
- Connect the equipment into an outlet on a circuit different from that to which the receiver is connected.
- Consult the dealer or an experienced radio/TV technician for help.

Any unauthorized changes or modifications to this equipment would void the user's authority to operate this device.

This device complies with Part 15 of the FCC Rules. Operation is subject to the following two conditions: (1) This device may not cause harmful interference, and (2) this device must accept any interference received, including interference that may cause undesired operation.

Responsible Party:  
Panasonic Corporation of North America  
One Panasonic Way  
Secaucus, NJ 07094  
Support contact:  
Panasonic Consumer Electronics Company  
Telephone No.: 1-800-211-7262

**Listening caution**



Selecting fine audio equipment such as the unit you've just purchased is only the start of your musical enjoyment. Now it's time to consider how you can maximize the fun and excitement your equipment offers. This manufacturer and the Electronic Industries Association's Consumer Electronics Group want you to get the most out of your equipment by playing it at a safe level. One that lets the sound come through loud and clear without annoying blaring or distortion-and, most importantly, without affecting your sensitive hearing.

We recommend that you avoid prolonged exposure to excessive noise. Sound can be deceiving. Over time your hearing "comfort level" adapts to higher volumes of sound. So what sounds "normal" can actually be loud and harmful to your hearing.

Guard against this by setting your equipment at a safe level BEFORE your hearing adapts.

To establish a safe level:

- Start your volume control at a low setting.
  - Slowly increase the sound until you can hear it comfortably and clearly, and without distortion.
- Once you have established a comfortable sound level:
- Set the dial and leave it there.
- Taking a minute to do this now will help to prevent hearing damage or loss in the future. After all, we want you listening for a lifetime.